

Instruction Manual

# Eagle 5

1:72 Scale Model Kit



***MAKE SOMETHING!***

Notes on: Printing,  
Assembly & Finish

## Eagle -5

---

The Eagle 5 is a fictional Winnebago-class space RV from *Spaceballs* (1987), manufactured by the equally fictional Winnebago Interstellar, a subsidiary of Schwartz Motors Corporation. Based on a heavily modified 1986 Winnebago Chieftain 33, this clunky yet oddly charming spacecraft is equipped with twin sublight engines, a hyperjet propulsion system, and oversized chrome rocket thrusters mounted on the rear. While primarily built for leisurely space travel, the Eagle 5 is also capable of Ludicrous Speed—though its structural integrity and occupants' safety are highly questionable at such velocities. Piloted by the roguish Lone Starr and his loyal mawg co-pilot, Barf, the ship is outfitted for long-haul space travel with a kitchenette, fold-out sleeping quarters, and Barf's personal sleeping area—complete with a fire hydrant for that extra touch of canine comfort. The dashboard, of course, is perpetually cluttered with fast food wrappers, proving that no matter how far you travel, you can't escape road trip chaos.

### Technical Specifications

---

**Manufacturer:** Winnebago Interstellar

**Model:** Chieftain 33

**Cost:** 180,000 space bucks

**Technical specifications:**

**Length:** 10.36 meters

**Maximum Speed:** Ludicrous

**Avoidance systems:** Radar Jammer

**Navigation system:** Equipped

**Crew:** 1 pilot

1 co-pilot



Parts Diagrams

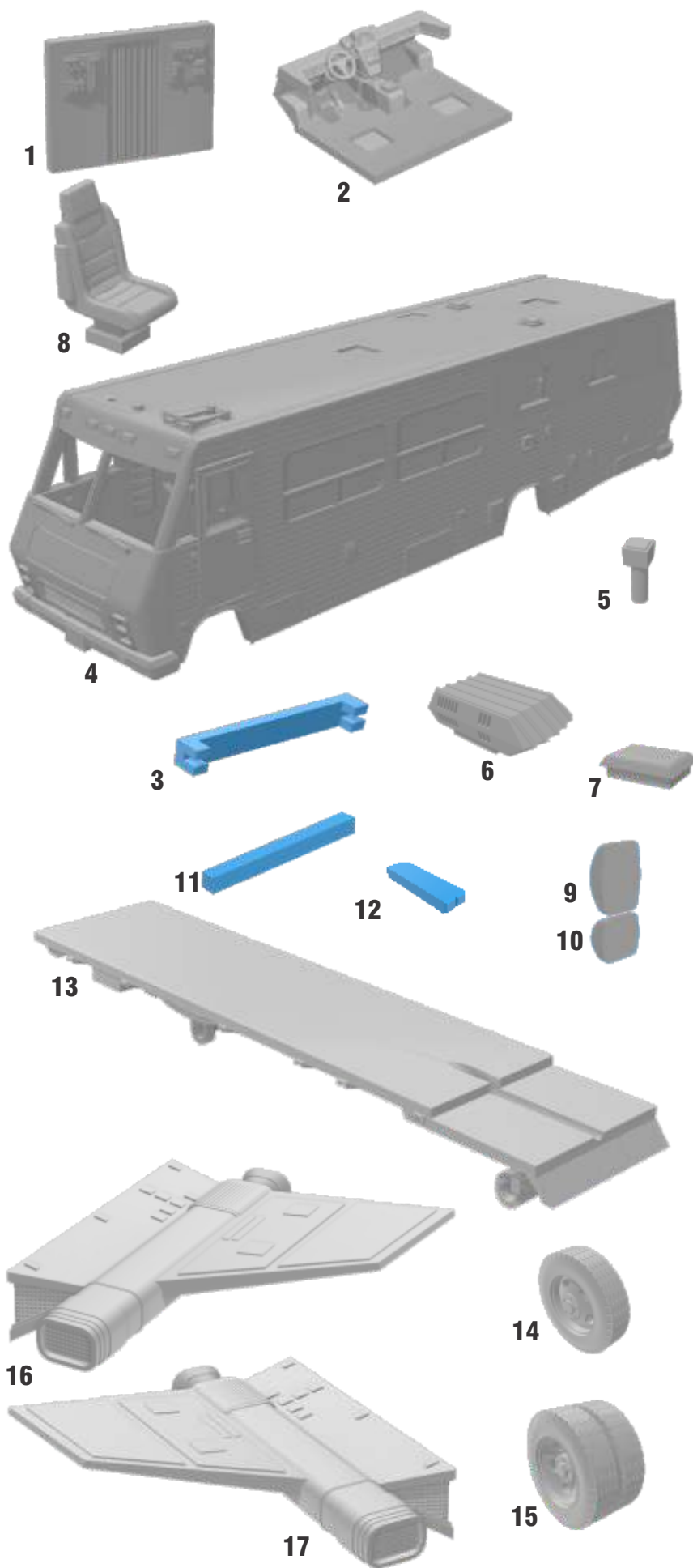

Parts List

- 1 .....Cockpit Wall
- 2.....Cockpit
- 3.....Headlights (Clear)
- 4.....Hull
- 5.....Periscope
- 6.....Roof Unit (x2)
- 7.....Roof Vent
- 8.....Seat (x2)
- 9.....Side Mirrors Tall (x2)
- 10.....Side Mirrors Short (x2)
- 11.....Tail Light Connector (Clear)
- 12.....Tail Lights (x2) (Clear)
- 13.....Chassis
- 14.....Wheel Front
- 15.....Wheel Rear Dualie
- 16.....Wing Left
- 17.....Wing Right

Assembly Symbols



Glue



Don Not  
Use Glue



Choice

# Assembly

1

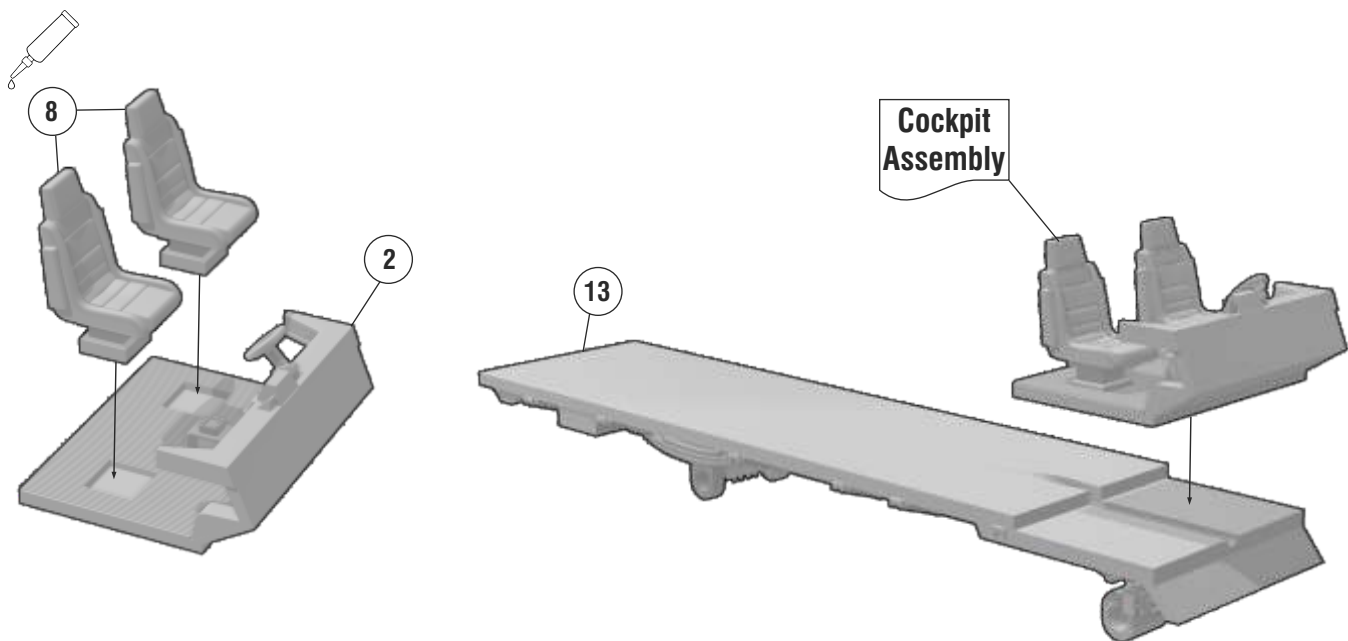

2

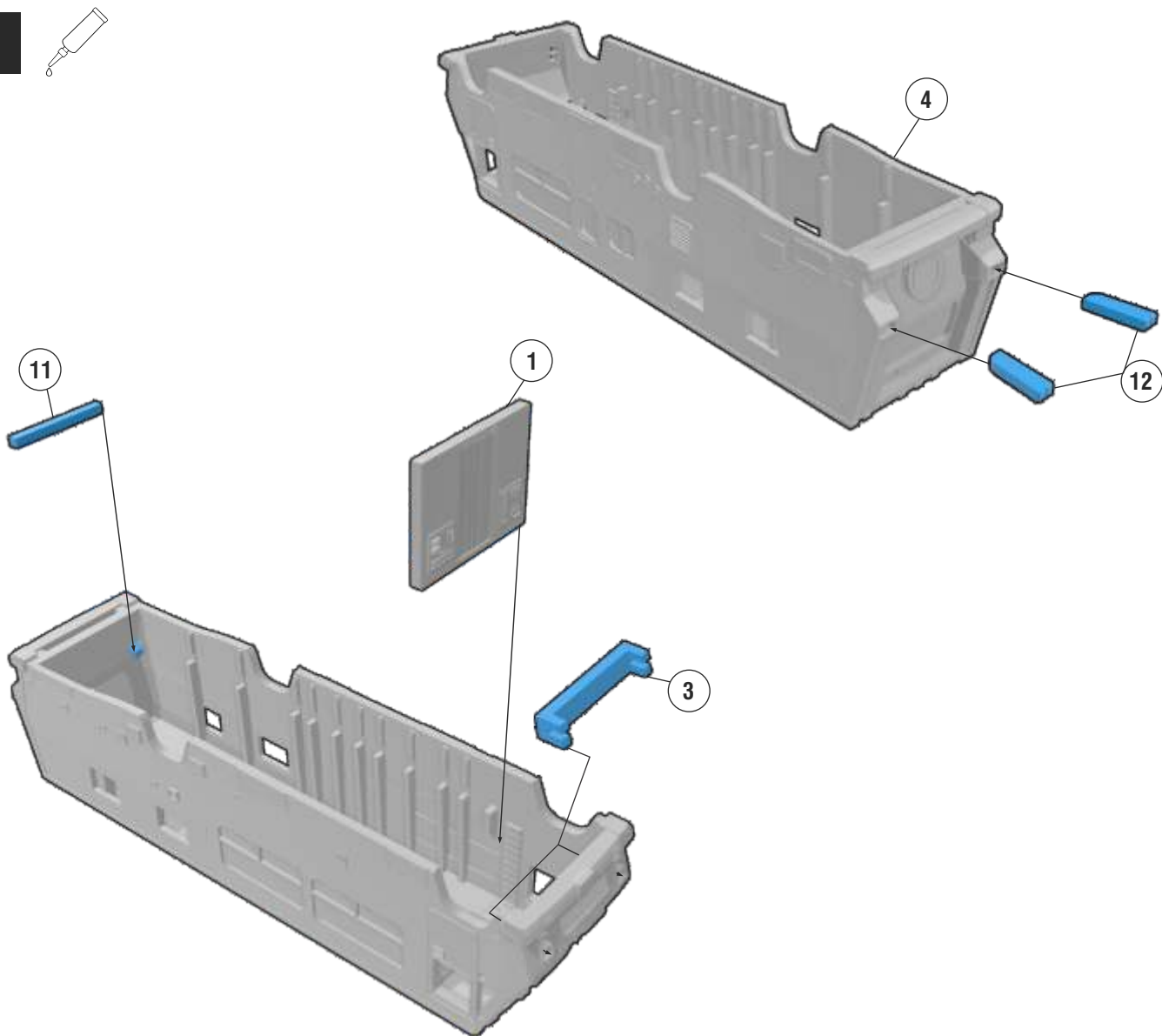

# Assembly

3

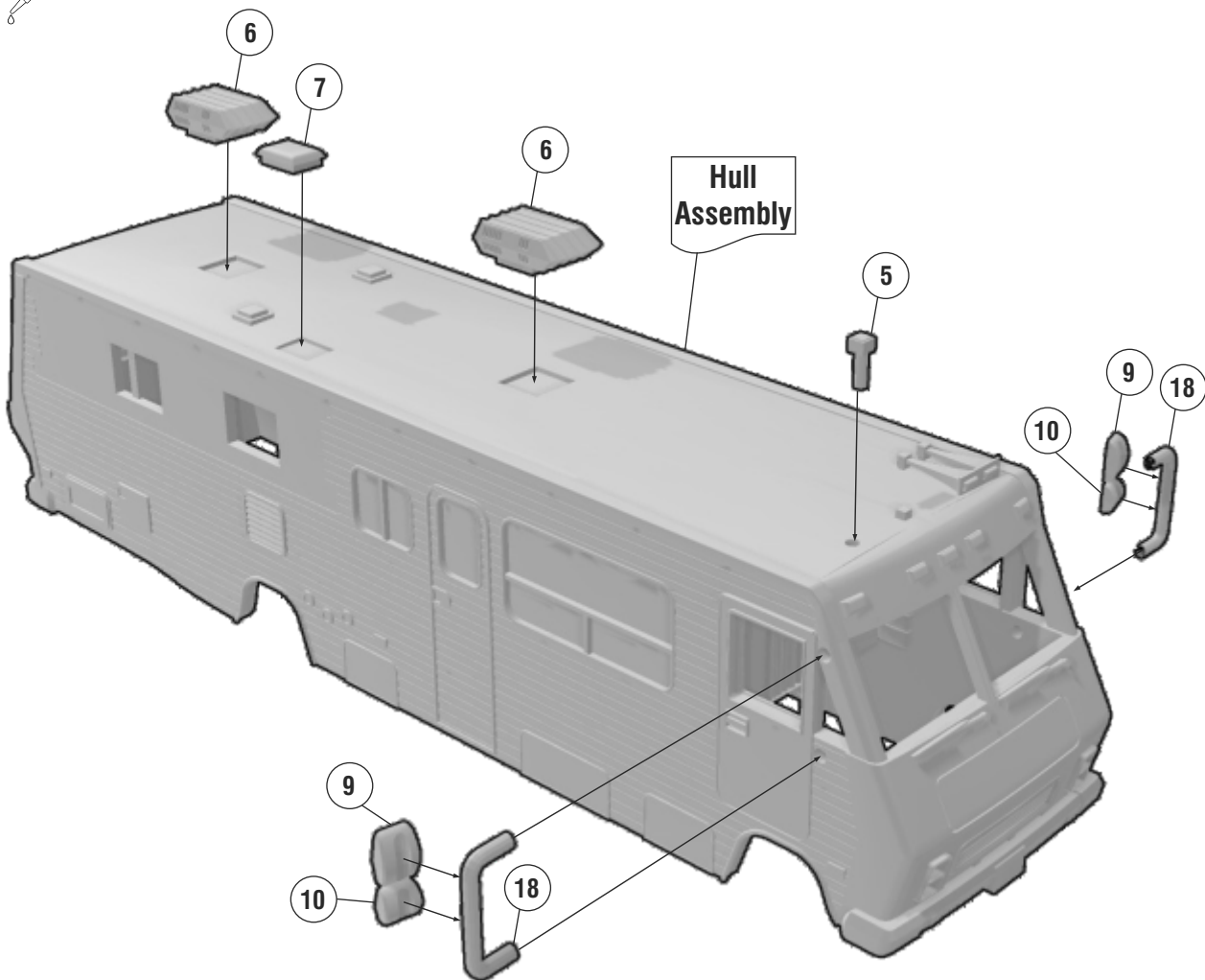

4



«?»



If you have added lights you may want to skip glue on this step in order to access any electronics.

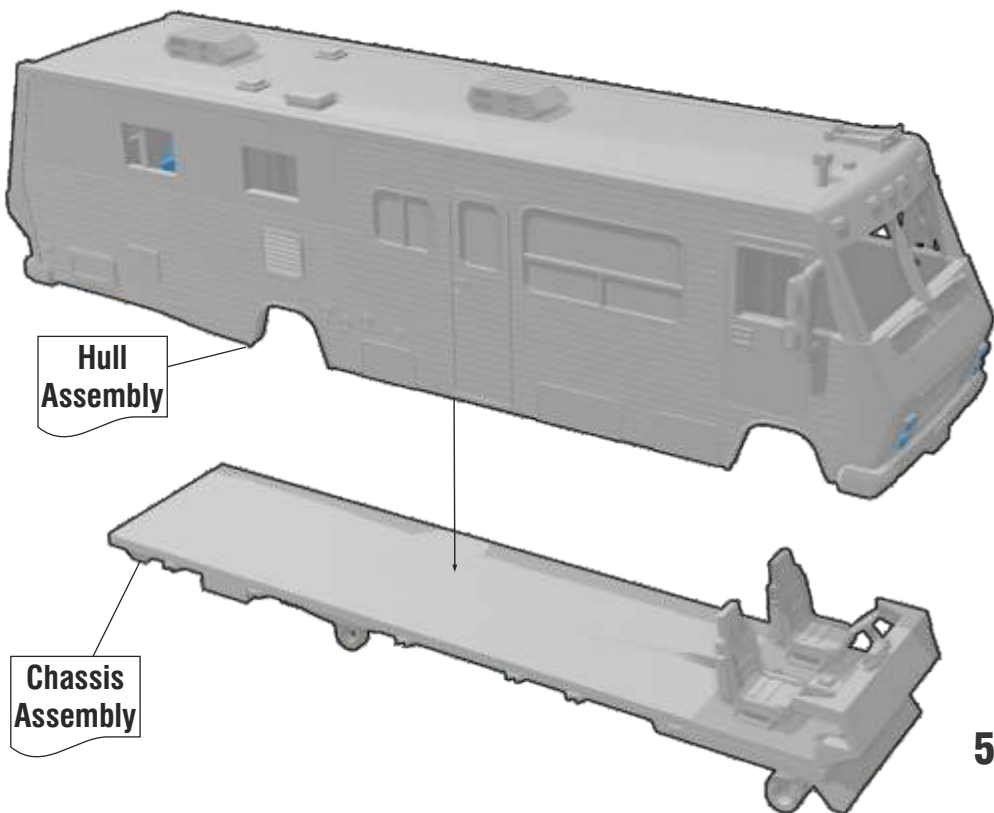



5 

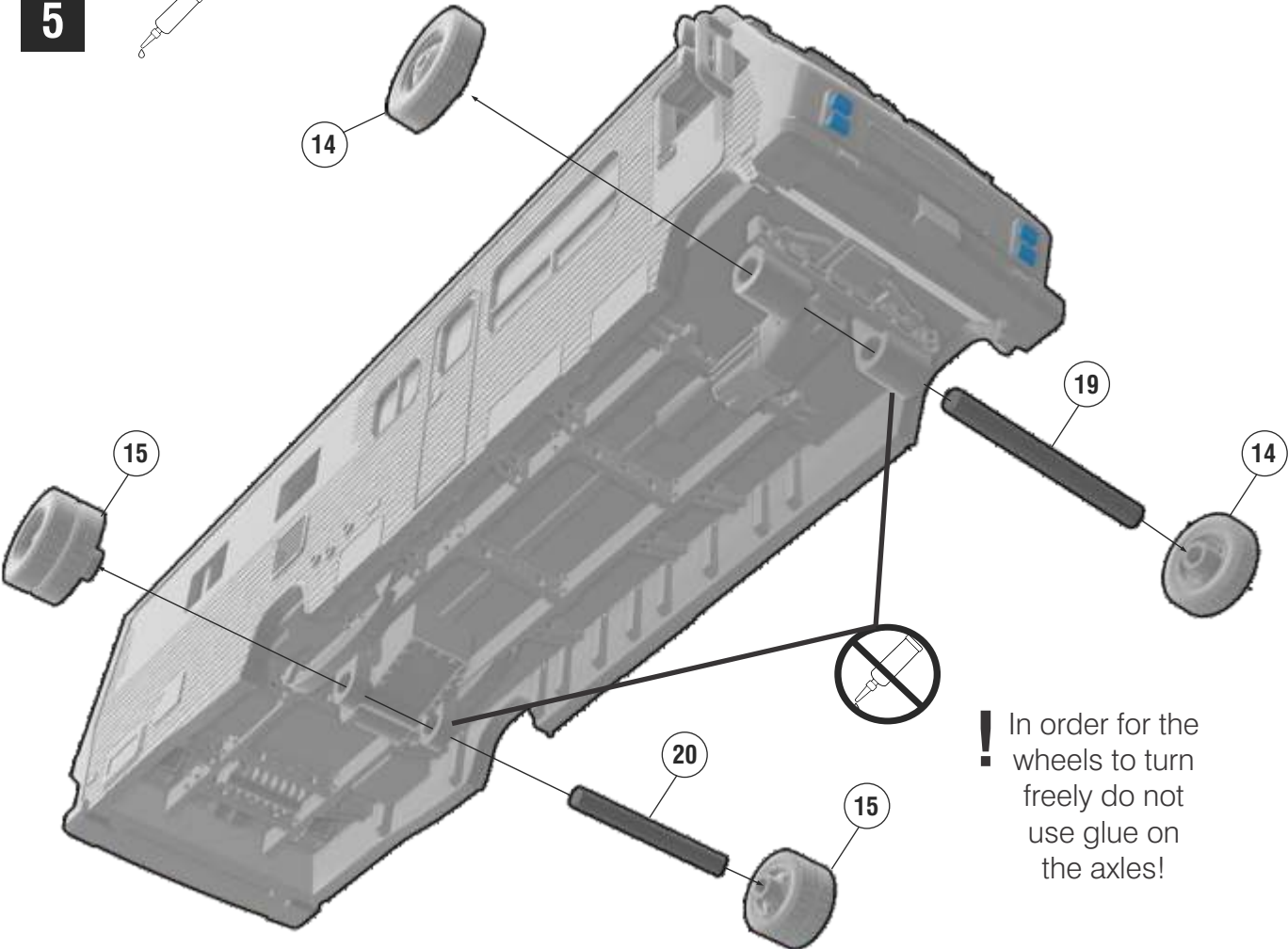

6 

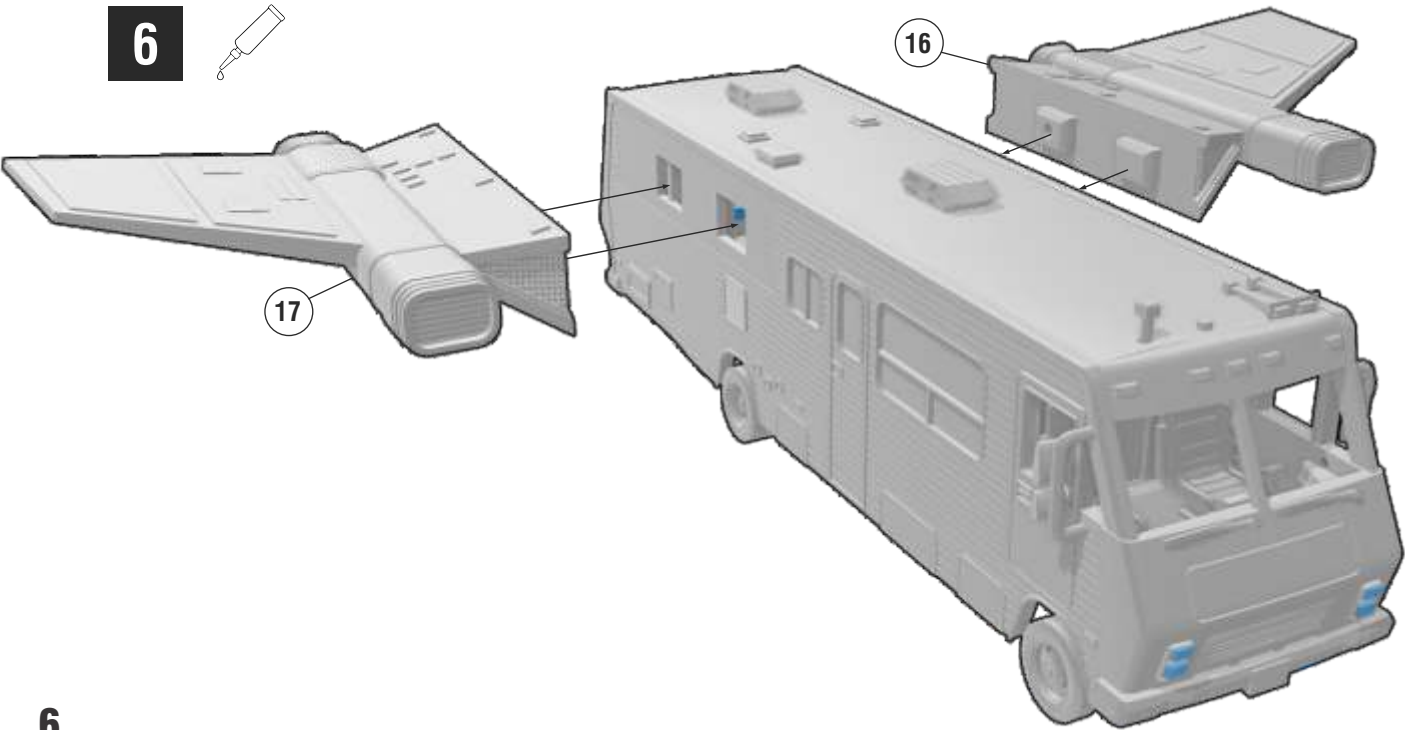

## Electronics

---

To Light or not to light. That is the question.

There is not space here to address all of the ins and outs of electronics in scale models but I do want to point out a few features of this kit available to those of you who would like to add lights.

The wings have 2.5mm curved tunnels to accept micro smd lights for the thrusters and there is a groove in the chassis to run wires for the headlights.

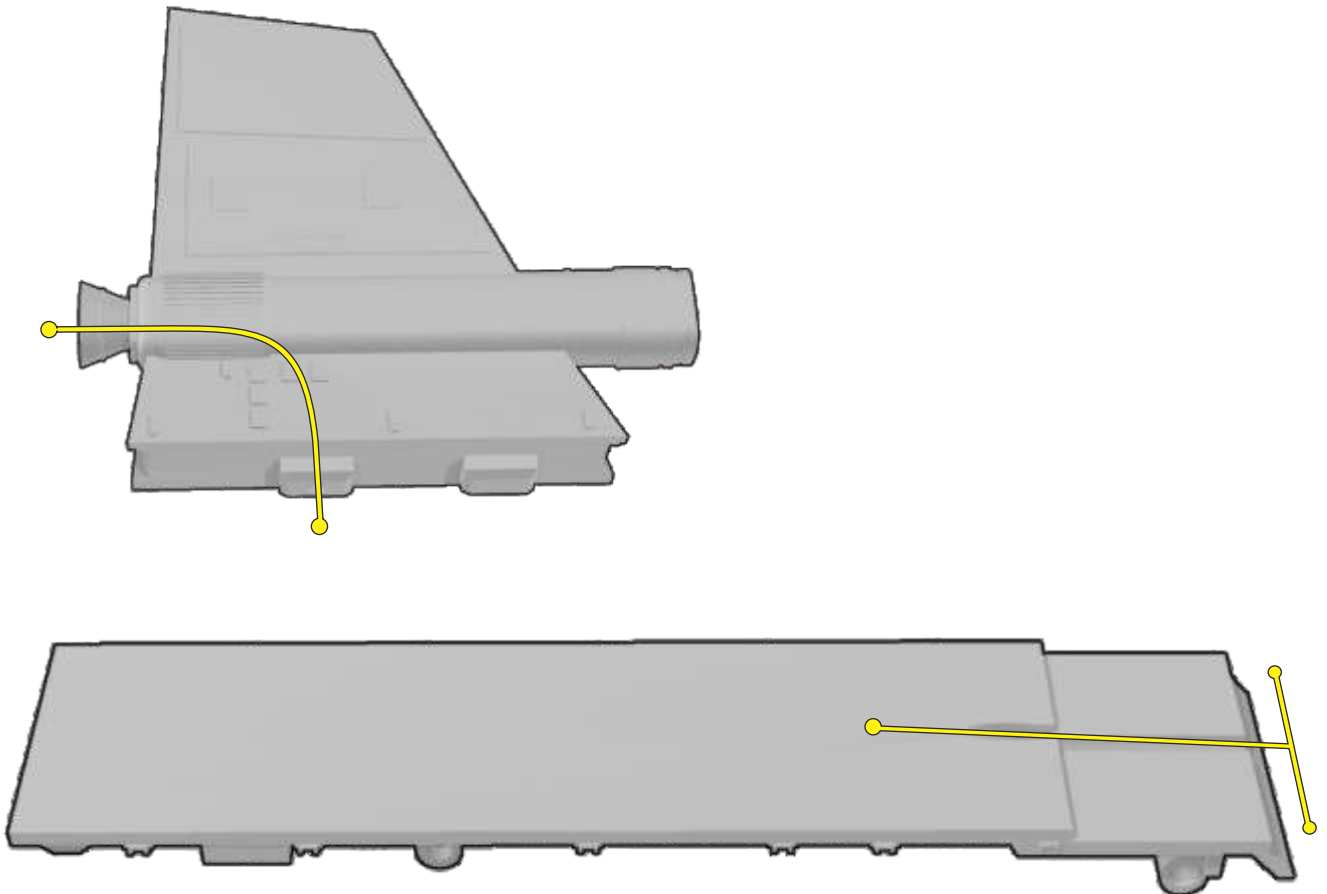

If you have never tried lighting scale models before I would point you toward the wonderful world of Youtube. That's how I started and am still learning. It's a great place to start learning a new skill. You've taken your first steps into a larger world!

Below are a few youtubers that I have found exceedingly helpful in my journey. look em up!

- [Ostrich Longneck](#)
- [Interstellar Modeler](#)
- [Luke Towan](#)
- [Afrotechmods](#)

## Color Reference



### A Word About Color

Paint colors on sci-fi models can be a hotly debated topic. The reference material I have available regarding color is pictured here. These images will vary slightly on different monitors and when printed by different printers. This is an approximation of the color and is only meant as a starting point. Your taste and interpretation of colors used may differ...

...and that's okay. At the end of the day it's your model and if you're happy with it then it's been a successful and worth while endeavor.

## Color Chart

\*Approximate color in Tamiya Acrylic paints

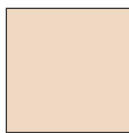

XF-55  
Deck Tan  
-Hull



XF-34  
Metallic Brown  
-Engine Intakes

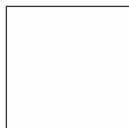

XF-2  
Flat White  
-Roof Vent, Roof Units



XF-20  
Medium Grey  
-Bumpers, Undercarriage



XF-16  
Flat Aluminum  
-Wheels, Air Horns Mirrors



XF-1  
Flat Black  
-Tires, Window Trim,  
Periscope



XF-64  
Red Brown  
-Seats



XF-15  
Flat Flesh  
Dash, Interior Walls



X-27  
Clear Red  
-Tail Lights



X-26  
Clear Orange (over silver)  
-Clearance Lights



X-24  
Clear Yellow  
-Headlights

*\*Use whatever brand of paint you like  
this is what I have and a starting  
point for your own research.*



# Decals

---

## Applying Water Slide Decals

1. Cut out the decal you want to apply using sharp scissors or a hobby knife.
2. Soak the decal in a small dish of room temperature water for 10–20 seconds.
3. Remove from water and let it sit on a paper towel for about 30 seconds until the decal starts to slide off the backing paper.
4. Moisten the model surface where the decal will go using a small brush or a damp paper towel.
5. Slide the decal onto the model by gently nudging it off the backing paper with a soft brush or your fingertip.
6. Position the decal carefully. You can move it slightly while it's still wet.
7. Blot away excess water with a soft paper towel or cotton swab—press gently to avoid shifting the decal.
8. Allow to dry completely for at least 1–2 hours.
9. (Optional but recommended) Apply decal setting solution like Micro Set or Micro Sol to help the decal conform to surface details. Follow the product's instructions.
10. Seal the decal with a clear coat (matte, satin, or gloss) to protect it and blend the edges.



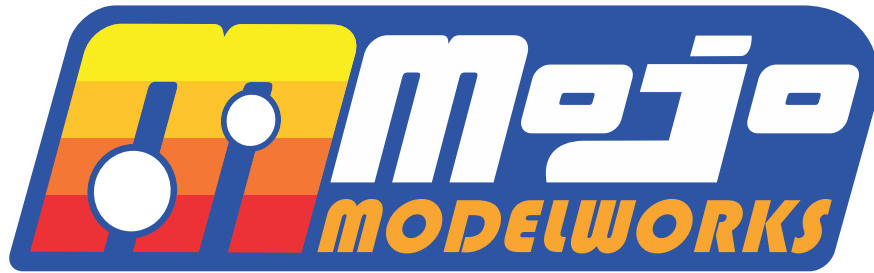

Facebook

[facebook.com/MojoModelworks](https://facebook.com/MojoModelworks)

Etsy

[etsy.com/shop/MojoModelworks](https://etsy.com/shop/MojoModelworks)

Follow the facebook page for upcoming projects and progress updates!

***MAKE SOMETHING!***